

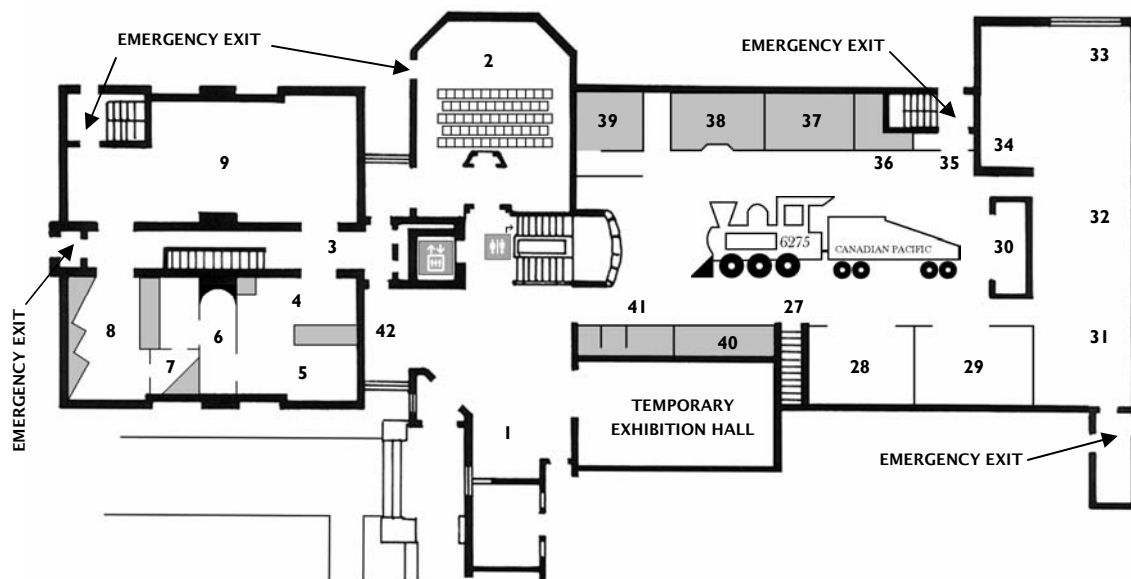

MAIN FLOOR

1. RECEPTION DESK
2. THEATRE
3. The HALLS of the 1856 school have been restored to the 1950s and these exhibits typify the manner and style of the installation used by Mr. J.H. Neill, the Museum's first Curator.
4. The NEILL GALLERY highlights the contribution made by the founding Curator. The Orchestral Regina is featured in this area.
5. MODELS created by Mr. Neill to illustrate pioneer skills and trades. Many of these move and the visitor is encouraged to "crank the handles".
6. The HURON COUNTY TIMELINE highlights events from 1810 to 1960.
7. IMMIGRATION TO HURON COUNTY — many of the settlers arrived in Canada by traveling "steerage" or as human cargo. The LOG SHANTY was the first home for many in the Huron Tract and was barely capable of keeping out the wind and weather.
8. The forests in Huron County had to be cleared in order to make way for settlers and their homes. The CLEARING THE LAND exhibit depicts the type of tools used to complete this task.
9. The LATTIMER GALLERY features exhibits on the Canada Company, Huron Tract and Municipal Government. The Canada Company was established in 1824. Over one million acres of land was purchased, most of which lay within the boundaries of Huron County. Three key players were John Galt, William Dunlop and Col. Van Egmond.

10 — 26 ON SECOND FLOOR



27. HURON COUNTY MAIN STREET is dominated by a 60-foot-long 1913 steam locomotive. The CP locomotive was used at the Goderich yard at the harbour until the late 1950s when it was purchased by Mr. Neill with the assistance of members of the community who bought "shares".
28. UNDERTAKER — two hearses, coffins, caskets and shadow boxes can be seen here. The shadow boxes are decorative items constructed of everything from seeds to human hair and were popular winter pastimes at the turn of the century.
29. This building is all that remains of the original WINGHAM FIRE HALL. It houses a steam pumper from Goderich and two hand pumpers, one from Clinton and one from Crediton.
30. TRAIN EXHIBIT
31. STATIONARY STEAM ENGINE manufactured by Goldie & McCulloch Co. Ltd. of Galt (Cambridge), Ontario. The engine uses the 'Jerome Wheelock System' patented on May 25, 1886.
32. STEAM POWER ON THE FARM — the large steam-driven machine was used to place drain tiles in farmers' fields.
33. THRESHING MACHINE
34. THREE-HORSE TREADMILL was used to provide power for small operations like threshing and separating wheat from chaff.
35. TELEPHONE SWITCHBOARDS
36. PHOTOGRAPHY — cameras from the 1880s to the 1930s are exhibited here. Note the black and white studio backdrop.
37. PRINTING — the production of local newspapers was a very important aspect of the growth and development of the area. Many

- of the towns and villages in Huron County have weekly newspapers that saw their beginnings back to the 1840s and 1850s.
38. HARDWARE and general merchant. The three stores (38, 39, 40) are from the village of Wroxeter and come from a building demolished in 1988. All of the woodwork is original.
39. There were many small churches like this in Huron County.
40. DRESS SHOP — this unique semicircular window comes from the Queen's Hotel in Brussels. This building was demolished in 1986 to make way for a new food store. It was the original home of Mrs. Maggie Rutledge's Restaurant and Pool Hall. Here, it features dresses from the 1880s to 1910.
41. Scheduled for redevelopment in Summer 2007.
42. This DOTY ENGINE was manufactured in Goderich. The Doty Engine Co. Ltd. was located on Victoria Street and manufactured small marine steam engines. This example was used in tug "ELGIN E" which was launched at the Collingwood shipyards in 1908. The engine is known as a 10-20 and produced 80 - 100 h.p.

Huron County Museum

110 NORTH STREET
GODERICH, ONTARIO N7A 2T8

Phone: 519-524-2686 Fax: 519-524-1922
museum@huroncounty.ca
www.huroncounty.ca/museum

SECOND FLOOR

I — 9 ON MAIN FLOOR

10. **SECOND FLOOR HALL** — as with the downstairs corridor, this one is restored as it appeared before the Museum underwent a major renovation. Mr. Neill mounted pulley wheels in the ceiling in order to assist with bringing large artifacts to the second floor. Many hand tools common around the farm are displayed on the walls.
11. **INDUSTRY IN HURON COUNTY** was not long coming and by the 1870s steam had arrived. Factories flourished and many other goods were manufactured ranging from steam farm equipment (Bell of Seaforth) to textile mills (Benmiller) to organ factories. The marine industry evolved along the shoreline.

12. **SALT** was discovered in Huron County in the late 1850s and soon there were many evaporator systems. It was in the early part of the 1900s that the supply of wood needed to fuel the evaporator system became scarce. All of the trees had been cut down and salt production ceased to be economically feasible. Goderich is now the only remaining location that has an active salt industry.
13. **THE LINK TRAINER** — this is the first flight simulator ever invented and was used how to teach a pilot how to use the instruments correctly and provided the safety of never leaving the ground.
14. Victorian architecture in Goderich is very rich. The house visible from this location dates back to the late 1800s.
15. The **MUSEUM LOUNGE** is furnished by the “Friends of the Museum”.
16. The entrance to the **MILITARY GALLERY** depicts the memorial chapel which was formerly housed in the Court House until the mid-1990s.

17. Suspended above the WWI Howitzer is a 1/4 scale replica of a deHaviland Tiger Moth airplane, the primary trainer in use by the RCAF during WWII.
18. **SHERMAN TANK** from WWII.
19. A uniform of the 33rd Huron Regiment from 1866.
20. Scheduled for redevelopment in Summer 2007.
21. **WIND POWER** was extremely important to the early farmer. Three windmills are on exhibit here.
22. **HORSE POWER** was the main form of energy used until the early part of this century. A horse-drawn seed drill, plows, harnesses, collars and other small implements can be seen here.
23. **CARVINGS BY MR. GEORGE JUNE** depict life on the farm. Note the fine detail in the figures and the well-crafted collection of canes.
24. **TRANSPORTATION** — horse-drawn Democrat, cutters and show buggies.
25. **FURNITURE GALLERY** — this apartment features a bedroom suite built in 1890 exclusively for A.A. Bennett of Clinton. It was later owned by Dr. Shaw (also of Clinton). The painting above the fire place in the parlour is that of Miss Eloise Skimmings, “Poetess of Lake Huron” during the 1890s.
26. The stairs from the apartment lead to the Huron County **MAIN STREET** exhibits. Pictures of members of the Royal Family from the turn of the century are displayed on the walls.

27 — 42 ON MAIN FLOOR

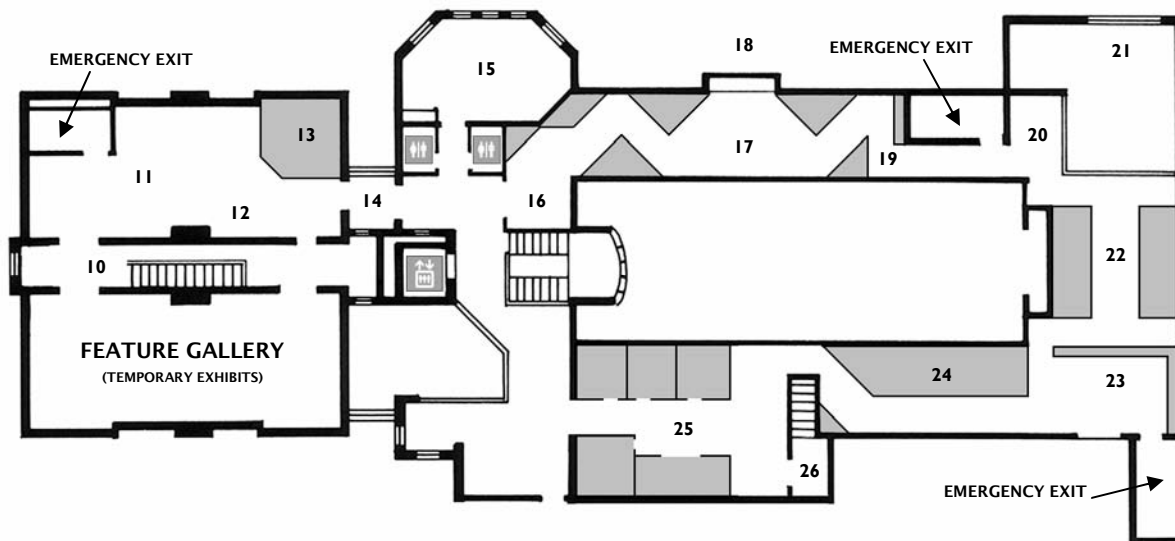

This guide has been developed to assist you with your visit to the Huron County Museum. We hope that you enjoy your stay with us and we look forward to answering any questions that you may have.

For further information about the Museum and our exhibits, please do not hesitate to ask one of our staff members.

Our job is to make your visit here a pleasant one.



Washrooms and cloakroom are located in the basement below the main lobby.



Accessible washrooms are located on the second floor, just outside the Lounge (15).



Diaper change facilities are also located here.



A wheelchair and stroller are available for use by the Museum visitor. Inquire at the Reception Desk.

